

# YOUR DISTRICT RENEWED

# BCSD PROPOSED 2017 CAPITAL PROJECT

**Zero  
New Tax  
Impact\***

## Proposed District-wide Improvements & Updates:

- **Safety and Accessibility Improvements**, including updates to: smoke protection assemblies; non-compliant ADA handrails & bathrooms; fire rated doors & frames; emergency exit windows
- **Multi-Use Artificial Turf Field Installation at Beacon High School**
- **Rombout MS state-of-the-art Science Wing and Home & Careers Classroom**
- **Hammond Field Track Repairs**
- **General Maintenance Updates to most District Buildings**, including: bathroom partitions; unit ventilator repairs; classroom carpeting, flooring & ceiling tiles; exterior doors; pool lockers & scoreboard; roof replacements & repairs
- **Air Conditioning Installation on Second Floor of Rombout Middle School**



Beacon High School

Install Multi-Use Artificial Turf Field behind Beacon High School



Add Handicap Handrails



Roof Replacements & Repairs



Exterior Masonry & Flashing Repairs



Bathroom Accessibility Updates & Repairs



Upgrade Rombout Home & Career Suite

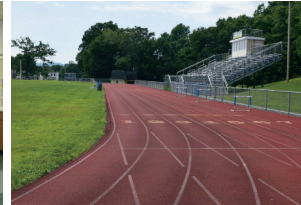

Hammond Track Repairs



Exterior Door Replacements



Air Handler Replacements

*Preliminary concepts and images. Final project may vary.*



Proposed State-of-the-Art Science Wing at Rombout Middle School

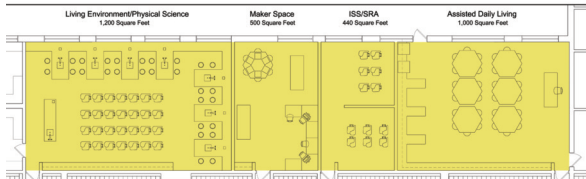

## Enhancing & Maintaining the Beacon City School District for a Successful Future

**VOTE** 7:00AM – 9:00PM  
**TUESDAY  
DECEMBER 5**

City of Beacon residents at Beacon HS  
Fishkill & Wappinger residents at Glenham ES



# BEACON CITY SCHOOL DISTRICT - PROPOSED 2017 CAPITAL PROJECT

## Renewing our School District for a Successful Future

The Beacon City School District is focused on delivering a safe and nurturing educational experience for all students. After an extensive planning process by our Board of Education, staff and community stakeholders, our proposed Capital Project promotes an enhanced learning environment that strengthens and maintains our ability to provide a modern, safe infrastructure for learning. BCSD's Capital Improvement Plan is a roadmap for the growth and improvement of the District's physical spaces.

This Capital Project is contingent upon the District securing the necessary funding. The Beacon City School District will hold a **Special School District Vote on Tuesday, December 5, 2017** for approval of the following Bond Resolution:

*"Shall the September 25, 2017 bond resolution authorizing the issuance of \$7,652,998 bonds to pay costs of the reconstruction of and improvements to school facilities, site work and incidental costs, at a maximum estimated cost of \$8,995,000 (30 year maximum maturity); the expenditure of \$1,000,000 capital reserve funds and \$342,002 EXCEL funds therefor, providing for a tax levy therefor in annual installments; pledging the District's faith and credit for debt service; delegating power with respect to bonds and notes; and providing for an estoppel procedure, be approved?"*



### \*ZERO NEW TAX IMPACT ON OUR DISTRICT

This Capital Project is the most fiscally responsible way to Maintain and Upgrade our District. Building Aid funds are currently available from the State which reimburses 66.9% of the costs. In addition, a balance of funds remaining from the EXCEL project, funds in our Capital Reserves, and a decrease in our district debt, all contribute to allow the project to be funded with **NO NEW SCHOOL TAX INCREASES.**

For more information on the BCSD 2017 Capital Project Bond Resolution, please visit our website at [www.beaconk12.org](http://www.beaconk12.org)

**JOIN US** as we share information about this project at each of our school's regularly scheduled November PTA/PTO meetings, and at the following community-wide public forums:

**November 16 at 7:00 pm**

City of Beacon Recreation Department, 23 West Center St.

**November 30 at 7:00 pm**

Beacon High School

### BEACON CITY SCHOOL DISTRICT

10 EDUCATION DRIVE  
BEACON, NY 12508

### POSTAL PATRON

NONPROFIT ORG  
U.S. POSTAGE  
**PAID**  
NEWBURGH, NY  
PERMIT #8112